

LEON

OPERATOR MANUAL



BALE HANDLER BH855 MODEL

LEON'S MFG. COMPANY INC.

P.O BOX 5002 135 York Road East Yorkton, Saskatchewan, CDN S3N 3Z4

Toll Free: 1-800-667-1581 Phone: (306) 786-2600 Fax 306-782-1884 E-mail: Sales@leonsmfg.com

Website: www.leonsmfg.com

TABLE OF CONTENTS

LEON'S BH855 BALE HANDLER INFORMATION	1
A WORD ON SAFETY	1
POST DELIVERY ASSEMBLY	2
PRE-OPERATION INSPECTION	3
PRE- OPERATING PROCCES	4
LOADING-UNLOADING BALES	4
ON ROAD TRANSPORTATION	5
STORING YOUR BH-855	6
BH-855 SPECIFICATIONS	6
DEALER / CUSTOMER INFORMATION	10
DELIVERY INSPECTION	11
WARRANTY (OWNER'S COPY)	12
WARRANTY (MANUFACTURING COPY)	14

NOTE: THIS MANUAL APPLIES TO ALL MODELS MANUFACTURED IN 2013 AND LATER.

LEON'S BH855 BALE HANDLER

The Leon's Bale Handler- BH855 is designed to load, transport, and unload a wide range of round bale sizes. They ranged from (48in.) in length (1500 lbs.) to (72in.) in length (2500 lbs.)

The arm is designed to give the bale a spin before picking it correctly in the cradle. The arm is adjustable to fit all bales ranges by sliding the Bale arms, #11 & #12,

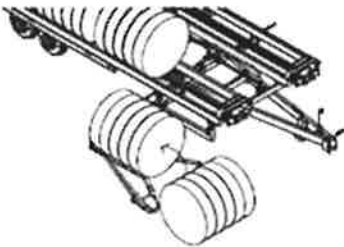
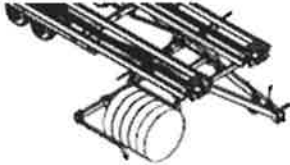

BALE DEFLECTOR

page (8), to the required distance depending on the Bale size. Use the $\frac{3}{4}$ " UNC Hex bolts and secured them with the $\frac{3}{4}$ " Hex nuts, #6. Also adjust the bale deflector, #13, to the required bale size. This pickup arm is mounted to the right side of the handler with adjustable forks that cradle and lift bales onto the deck. The Bale Handler is equipped with a deflector that is mounted to the fork, this deflects the bale gently and rotates it into the pickup arm without damaging the bale.

The Bale Handler's low-profile design offers excellent visibility, and gives the operator clear vision of the loading arm and the loading cycle.

A WORD ON SAFETY

As a person, you cannot be replaced. *Think about it.*

- Always be safety conscious person.
- Put safety into each step of your workday;
- Read your owner's manual thoroughly;
- Know how to operate each machine properly and safely;
- Think before you act.
- Make sure you think about tomorrow.
- Safety today insures health and life for tomorrow.
- Outfit yourself with a safety program now.

The following safety precautions should be thoroughly understood before attempting to begin assembling this machine:

- Do not lift heavy parts or assemblies. Use crane, jack, tackle, fork trucks or other mechanical devices.
- Preview the assembly instructions in your operator's manual before proceeding further.
- If the assembly instructions call for parts or assemblies to be blocked up, use, only, blocking material that is in good condition and is capable of handling the weight of the assembly to be blocked. Also insure that the blocking material is on a clean, dry surface.
- Never put hands, or any part of body, under blocked up assemblies if at all possible.
- After completing assembly, thoroughly inspect the machine to be sure that all nuts, bolts, hydraulic fittings or any other fastened assemblies have been thoroughly tightened.
- Before operating the machine, thoroughly read the operation section of your operator's manual.

Before operating equipment – If you have any questions regarding the proper assembly or operation, contact your dealer.

POST-DELIVERY ASSEMBLY

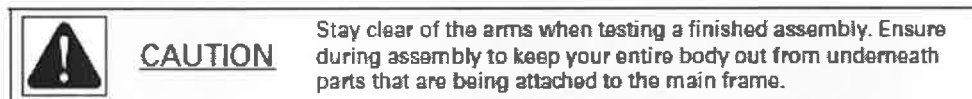

The Bale Handler may have been partially disassembled for shipping. If assembly is required, please follow the instructions below:

1. Install the Tandem axle assembly into the main frame. The long side of the tandem axle goes towards the front of the unit, please see page (9) on the parts manual.

2. Secure the axle with axle retainer and lock into place with the ¾” hex nut and then lock the hex nut with the ¾” hex jam nut.
3. Fill cavity between tandem axle bushings with a premium quality multi-purpose grease.
4. Install the wheel/tire assemblies on the axles and secure with wheel bolts or wheel nuts. The wheel torque required is 180 ft.-lbs.
5. Check the tire inflation pressure as per requirements. The required tire pressure is 60 PSI.
6. Install the Arm-main, #10, in its position using the pins #14 and secured them with the 3/8” Hex bolts, #1, page (8).
7. Adjust the Bale arms, #11 & #12, by sliding them to the required distance depending on the Bale size. Use the ¾” UNC Hex bolts and secured them with the ¾” Hex nuts, #6. Also adjust the bale deflector, #13, to the required bale size, page (8).
8. Connect the hydraulic cylinder, #8, with the main arm with the pin #9 and secured it with pin retainer clips, #15, page (8).
9. Ensure that the safety SMV [Slow Moving Vehicle] emblem have been installed properly.
10. Ensure all the bolts and fasteners are in place and properly tightened.

PRE-OPERATION INSPECTION

This inspection is ensuring a proper operation of the Bale Handler. It should be carried out prior to operation and daily thereafter.

1. Check and maintain the tires pressure of 60 PSI
2. Check for any loose bolts
3. Energize the hydraulics to the cylinders in order to fill them up. Operate each cylinder, individually, to insure it work properly.
4. Inspect the hydraulic system for leaks or any other damages
5. Repeat step (3) several times till the hydraulic cylinders are free of air and they are working smoothly.

PRE OPERATING PROCCESS

- Always wear protective clothing and foot wear
- Ensure the tires are inflated to the recommended pressure
- Give the unit a visual inspection for any loose bolts, worn parts or cracked welds, and make necessary repairs
- Be sure there are no tools laying on the equipment
- Do not be in a hurry learning the process or take the unit for granted. Easy into it and become familiar with your new equipment
- Practice operation of your equipment
- Do not allow anyone to stand between the hitch and the towing vehicle when backing up the equipment.
- Do not allow anyone to stand between the arm and the deck when testing the equipment.

LOADING-UNLOADING BALES



Be sure that the push gate is at the front of the Bale Handler.

1. Align the tractor and the Bale Handler as indicated in the pictorial, page (1), for pick up method used.
2. Slowly approach the Bale
3. When the Bale is properly captured, begin to lift the Bale.
4. When the arm reaches its vertical limit, the Bale will roll of the fork onto the deck and it will roll to the other side of the Bale Handler with the assistance of the deflector plate.
5. Pick up the next Bale in the same way.
6. When there are two bales on the deck, use the push gate to push the bales backward far enough so that there is clearance for the next row of bales to be placed on the Handler.

7. The deflector on the arm allows the Bales to be picked up from either side: End one, fig (3) & Side one, fig (1). To pick up the Bales that are placed End side, drive in so that the inner arm of the loading fork is against the inner edge of the Bale. The Bale will then be loaded onto the Handler in the same direction as it was picked up, fig (3).
8. If the Bales are placed on the Side, fig (1), the deflector rotates the Bale 90° before it is lifted up onto the Handler. Forward moment will assist in rotate the Bale. Therefore, approach the Bale so that the outer end of the Bale rides up on the Bale deflector as the loading arm moves under the Bale.

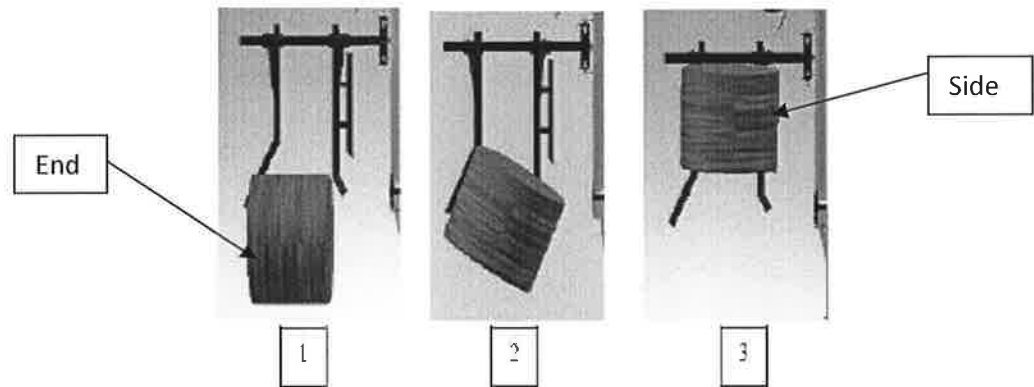

9. This operation must be executed while moving. This process will take some practice.
10. Repeat all above steps till the Handler deck is filled.
11. For Unloading, activate the tilt hydraulic cylinder to the maximum stroke, then activate the hydraulic pushing cylinder to start the unloading process and the Bales will be unloaded uniformly to the ground.
12. Simultaneously with step (11), start to drive the tractor forward to clear the area for the unloading procedure to complete.

ON ROAD TRANSPORTATION

- If you travel a certain distance with an empty BH-855, it is recommended to secure the loading arm is in the raise position.
- Stopping distance increases as weight, speed and ground slope increase.
- Always travel at a safe speed
- Check the local authorities regarding transport on public roads

STORING YOUR BH-855

- Store the unit in an area away from human activity.
- Do not permit children to play on or around the stored machine.
- Position the hydraulic lock to hold the loading arm in the vertical position
- Remove the hydraulic hoses from the tractor and hang them over the hook on the A-frame.
- Reposition the jack to keep it in level and facilitate the next hook-up.

BH-855 SPECIFICATIONS

Tractor Horsepower requirement.....	100hp+
Overall Length.....	388 inch
Deck Length.....	250 inch
Deck Width.....	120 inch
Overall width with Tires.....	184 inch
Overall height with the Arm.....	124 inch
Total weight of the unit.....	6000 LBS

Max load capacity (Two Rows) is:

48 inch-5 Bales per row X 2 rows = 15,000 LBS. (10 bales @ 1,500 LBS/ea.)

60 inch-4 Bales per row X 2 rows = 16,400 LBS. (8 bales @2,050 LBS/ea.)

72 inch-3 Bales per row X 2 rows = 20,000 LBS. (6 bales @2,500 lbs. /ea.)

Max load capacity (Top Row) OPTIONAL:

48 inch-4 Bales per top row = 21,000 LBS. (14 bales @ 1,500 LBS/ea.)

60 inch -3 Bales per top row = 22,550 LBS. (11 bales @2050 LBS/ea.)

72 inch -2 Bales per top row = 20,000 LBS. (8 bales @2500 lbs. /ea.).

Adjustable fork Arm capable of handling 4ft to 6ft diameter bales

A hydraulic tilting main deck for gentle unloading of the bales

A hydraulic push off gate system to push the bales off deck when unloading

TIRES AND WHEELS:

Tire: 16.5 x 22.5 farm casing

Rim: 11.75 x 22.5 x 8-bolts

Hub: 817 complete assembly

CYLINDERS:

	Push Cylinder	Arm Cylinder	Tilt Cylinder
Leon's No.	# 1460006	# 1125851	# 1125851
Bore Diameter	3.5" / 3.5"	3.0"	3.0"
Shaft Diameter	2" / 2"	1.25"	1.25"
Stroke	108" / Cylinder	13.25"	13.25"
Design Pressure	3000 psi	3000 psi	3000 psi
Test Pressure	3500 psi	3500 psi	3500 psi



Do not force the Bale to roll in over the deck deflector, let the second Bale do the job, otherwise that will lead to sever problems in the cylinder and the eye cylinder.

BH-855 - BALE ARM

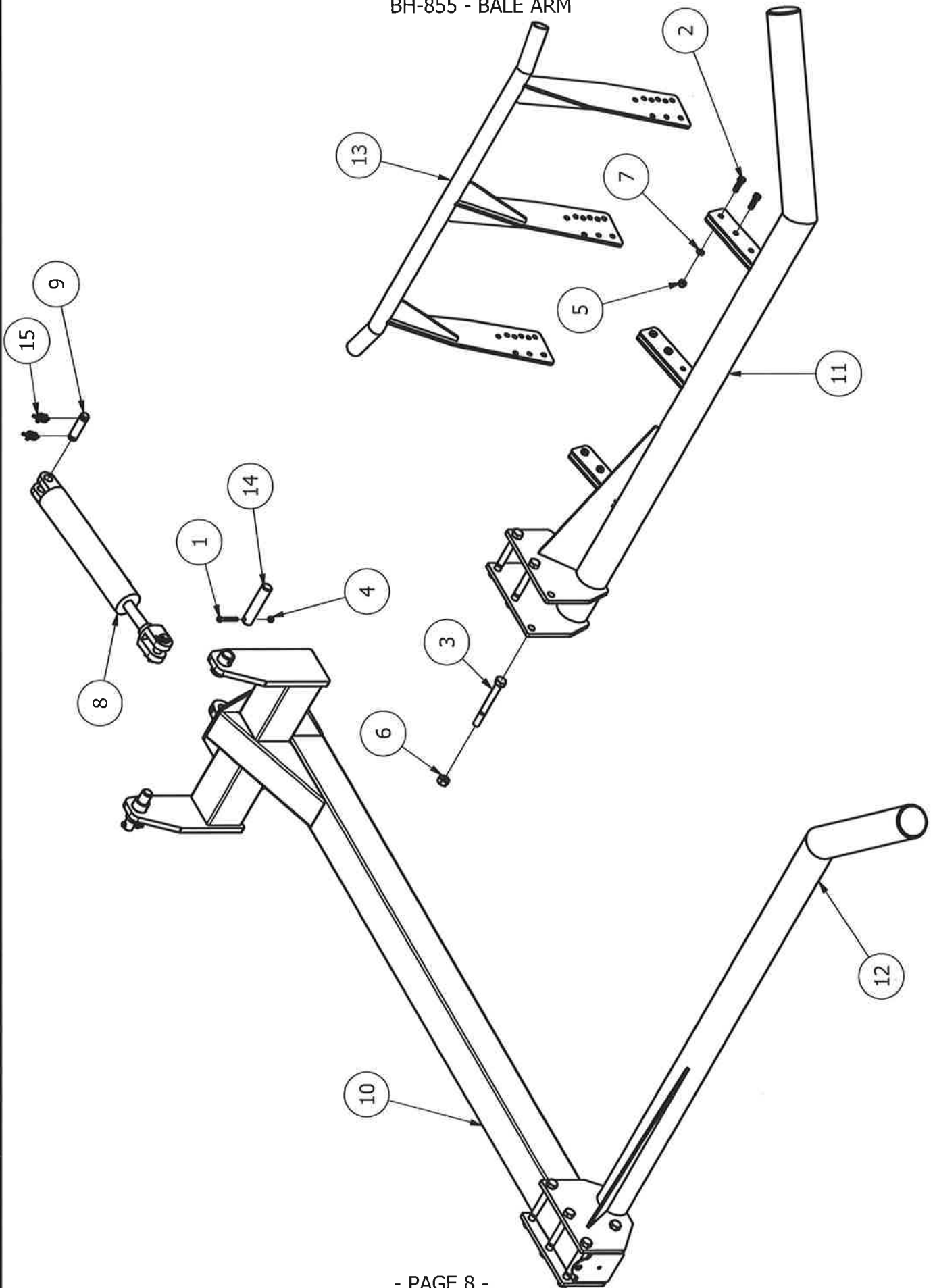

BALE ARM PARTS LIST			
ITEM	QTY	PART NUMBER	DESCRIPTION
1	2	1102004	3/8" X 2 1/2" UNC GR. 5 PLATED HEX BOLT
2	6	1102052	1/2" X 1 3/4" UNC GR. 5 PLATED HEX BOLT
3	8	1102161	HCS, GR 5, 0.750-10 UNC X 7.0 Lg
4	2	1102526	3/8" UNC HEX NYLOCK. NUT GR.5 PLATED
5	6	1102537	1/2" UNC HEX NYLOCK NUT, GR.5 PLATED
6	8	1102545	3/4" UNC HEX NUT GR.5 PLATED
7	6	1102592	1/2" SPLIT SPRING LOCK WASHER, PLATED
8	1	1125851	RL-30L-13.25
9	2	1225654	PIN - GROOVE - 2 7/8
10	1	1460055	BALE ARM - MAIN
11	1	1460060	BALE ARM - LEFT
12	1	1460065	BALE ARM - RIGHT
13	1	1460070	BALE DEFLECTOR-FORK
14	2	1460075	PIN - 1 1/4 X 6
15	4	1500115	PIN RETAINER CLIP

DEALER / CUSTOMER INFORMATION

TO THE DEALER:

Warranty Registration

The warranty registration form must be completed and signed by both dealer and customer before or upon machine delivery. Give the owner their copy.

Pre-Delivery

Using the Pre-Delivery Inspection Report, be sure the bale handler is completely set up, lubricated and in proper working order upon delivery to the customer.

Operator's Manual

The Operator's Manual is a very important part of the equipment purchase. With the use of the manual be sure to instruct the owner and operator regarding:

- Safety precautions
- Operation and adjustments
- Lubrication and maintenance

BE SURE to give this **MANUAL** to the **OWNER**.

TRANSPORTING

- Use a tractor with adequate power, adequate weight and with adequate towing and braking capacity to safely tow and handle the bale wagon.
- Always adjust the drawbar length to properly accommodate the bale handler as per the recommended connection specifications.
- Always use correct hitch pin size and secure the pin with a retainer clip or pin.
- Attach a transport safety chain between the tractor drawbar support and the bale handler hitch.
- Always lock tractor brake pedals together when traveling on a public road.
- Always make the necessary safety precautions prior to transporting the bale handler on public roads:
 - Be sure SMV (Slow Moving Vehicle) sign is mounted, clean and visible.
 - Use flashing warning lights where required by law. Ensure that they are clearly visible and in proper working condition.
- Comply with provincial or state and local laws and regulations governing highway safety when moving the machine.
- Use good judgment when transporting the bale handler on the highway. Maintain complete control of the machine at all times.

- When traveling up or down steep grades, use extreme caution to prevent the bale handler from jackknifing, overturning or causing loss of control of the towing vehicle.

TO THE CUSTOMER:

Warranty Registration

Be sure to sign the registration form and keep a copy.

Know the Equipment

Before operating the bale handler, read this operator's manual to become completely familiar with the machine.

Right and Left-Handed Sides of the Machine

Stand behind the machine and face the direction of travel to determine the right hand (RH) and left hand (LH) sides of the machine.

Serial Number

Record the bale handler serial number. The dealer needs this information to order parts and process warranty claims.

Authorized Service

For factory authorized service and parts, see your dealer. The dealer's trained service staff uses the latest service techniques, and the parts personnel provide prompt delivery of quality parts.

DELIVERY CHECKLIST

Pre-Delivery:

- _____ Verify Tires Pressure
- _____ Verify Wheel Torque
- _____ Inspect all Lubrication Points
- _____ Inspect all Hydraulic Hoses and Fittings
- _____ Inspect all Hydraulic Cylinder Pins
- _____ Verify Hydraulic Tighten Torque

DEALER REPRESENTATIVE: _____

DATE: _____

Customer Delivery :

- _____ Review Safety Procedures regarding Bale Handler Operation
- _____ Review Operator's and Part's Manual
- _____ Review proper Operating Procedure
- _____ Review the Assembly Procedure
- _____ Review general Adjustment and Setup procedure
- _____ Discuss Road and Highway Transportation Requirements and Regulations

DEALER REPRESENTATIVE: _____

DATE: _____

WARRANTY

REGISTRATION (OWNER'S COPY)

Leon's Mfg. Company Inc. warrants all products manufactured by Leon's Mfg. Company Inc. for a period of one year from the date of purchase for private use, or a period of 90 days for commercial use.

Leon's Mfg. Company Inc. warrants tires for a period of 60 days for private use or a period of 30 days for commercial use.

This warranty provides that the equipment shall be free of defective materials and workmanship, or we will replace or repair at our factory any part that our inspection shows to be defective.

If any product or portion thereof is modified, changed or tampered with in any way, this warranty shall be deemed null and void.

All hydraulic cylinders, valves, hoses, tires, spindles and other purchased products, except as specifically included in the warranty above, are not manufactured by Leon's and are, therefore, covered by the warranties of the manufacturer of these products.

All parts shipped to the factory shall be shipped prepaid and will be returned F.O.B. Factory. Leon's Mfg. Company Inc. does not assume responsibility for shipping, labour or travel expenses.

Although Leon's products are designed to minimize tractor strain, Leon's Mfg. Company Inc. will assume no responsibility for damage to tractors or other equipment.

Leon's Mfg. Company Inc. reserves the right to make improvements and reserve the right to change the design, materials and specifications without notice or obligation.

MODEL NO. _____ **DATE OF PURCHASE** _____

SERIAL NO. _____ **DEALER** _____

TOWN _____ **PROV. / STATE** _____

OWNER _____ **ADDRESS** _____

TOWN _____ **PROV. / STATE** _____

What make and model of tractor will this product be used with? - _____

Will this product be used: commercially? _____

Privately? _____

Why did you buy **Leon**? Advertising _____

Previous Owner _____

Recommendation _____

Special Features _____

Comments:

NOTE: This warranty is effective only if the warranty registration is filled in and mailed by the original purchaser within ten days after the date of delivery.

WARRANTY

REGISTRATION (MANUFACTURER'S COPY)

Leon's Mfg. Company Inc. warrants all products manufactured by Leon's Mfg. Company Inc. for a period of one year from the date of purchase for private use, or a period of 90 days for commercial use.

Leon's Mfg. Company Inc. warrants tires for a period of 60 days for private use or a period of 30 days for commercial use.

This warranty provides that the equipment shall be free of defective materials and workmanship, or we will replace or repair at our factory any part that our inspection shows to be defective.

If any product or portion thereof is modified, changed or tampered with in any way, this warranty shall be deemed null and void.

All hydraulic cylinders, valves, hoses, tires, spindles and other purchased products, except as specifically included in the warranty above, are not manufactured by Leon's and are, therefore, covered by the warranties of the manufacturer of these products.

All parts shipped to the factory shall be shipped prepaid and will be returned F.O.B. Factory. Leon's Mfg. Company Inc. does not assume responsibility for shipping, labor or travel expenses.

Although Leon's products are designed to minimize tractor strain, Leon's Mfg. Company Inc. will assume no responsibility for damage to tractors or other equipment.

Leon's Mfg. Company Inc. reserves the right to make improvements and reserve the right to change the design, materials and specifications without notice or obligation.

MODEL NO. _____ **DATE OF PURCHASE** _____

SERIAL NO. _____ **DEALER** _____

TOWN _____ **PROV. / STATE** _____

OWNER _____ **ADDRESS** _____

TOWN _____ **PROV. / STATE** _____

What make and model of tractor will this product be used with? _____

Will this product be used: commercially? _____
privately? _____

Why did you buy **Leon**? Advertising _____
Previous Owner _____
Recommendation _____
Special Features _____

Comments:

NOTE: This warranty is effective only if the warranty registration is filled in and mailed by the original purchaser within ten days after the date of delivery.

